

# Catapult

1.



The hollow plastic bushing fits snugly into the arm pieces

2.

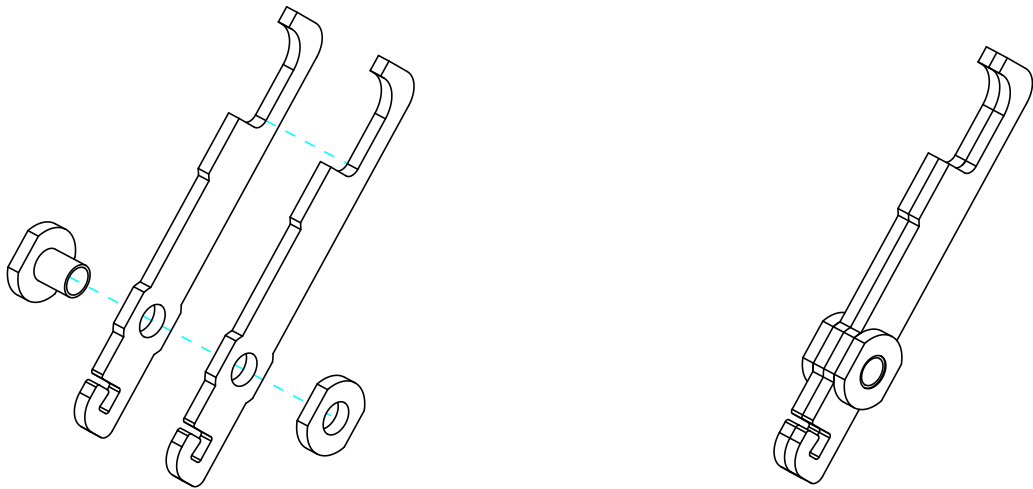

⊗ Don't glue the bushing in

3.

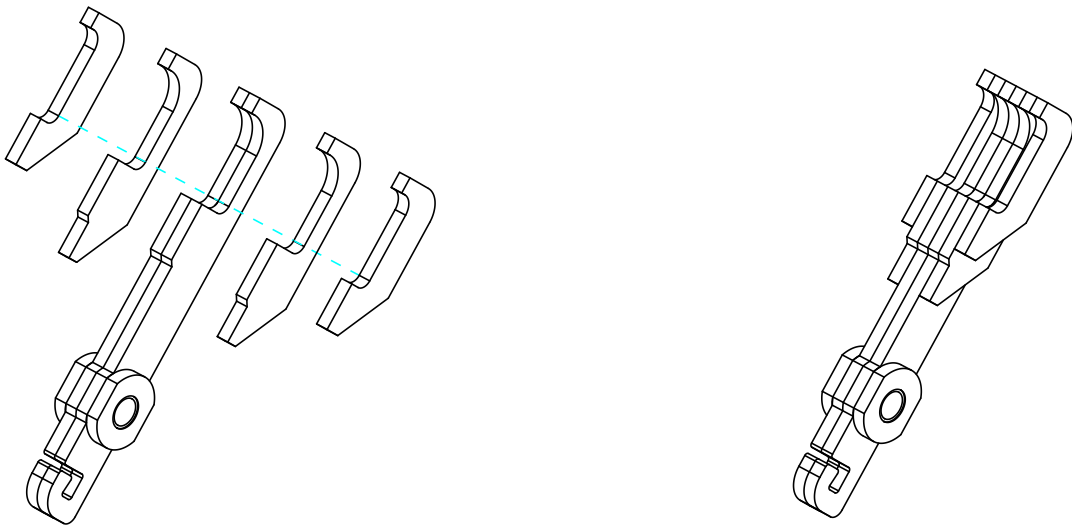

# Catapult

4. To align the pieces of the bucket, press the entire assembly against a flat surface

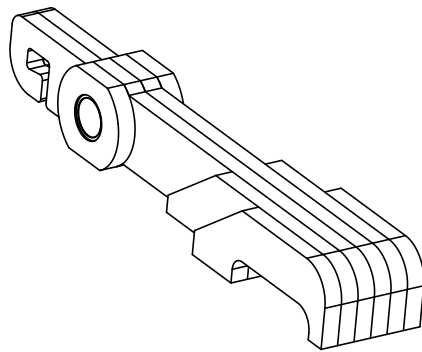
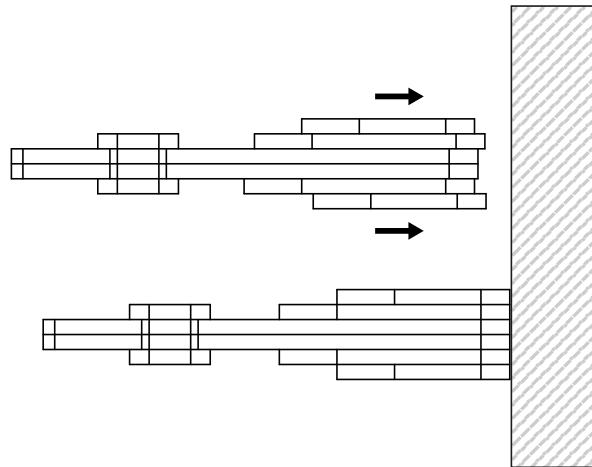
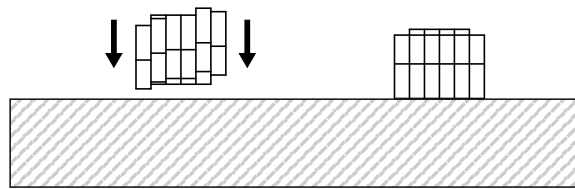

# Catapult

5.

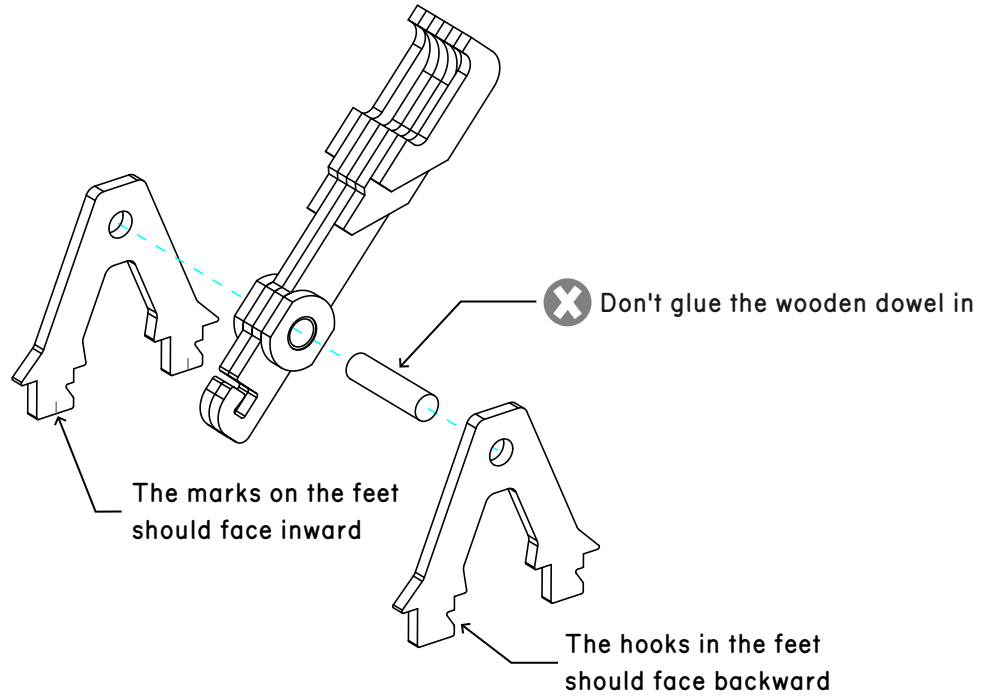

6.

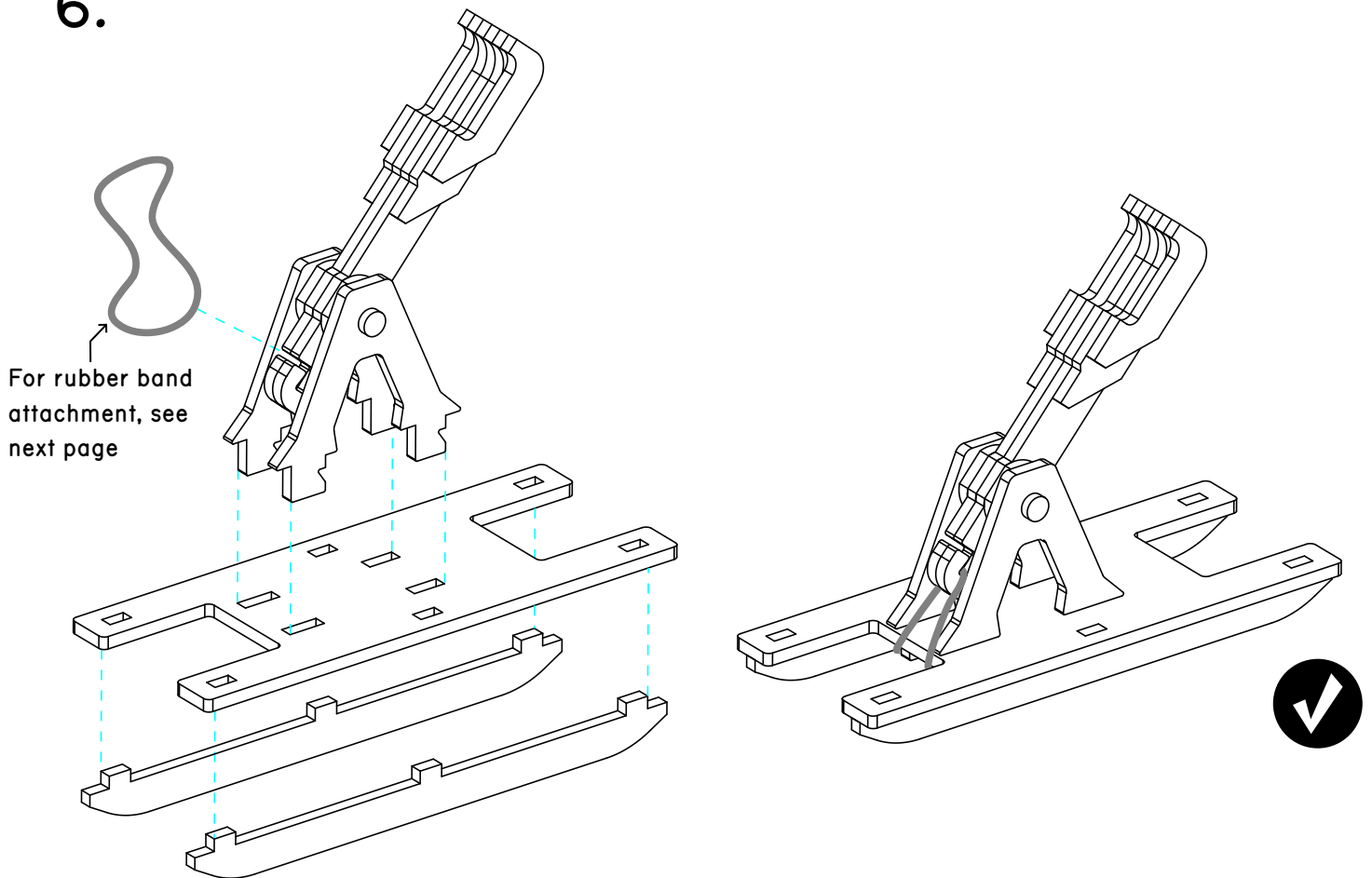

# Catapult - Rubber Band

Find this small, flexible tube with the rubber bands. Push or pull one end of a rubber band through it.

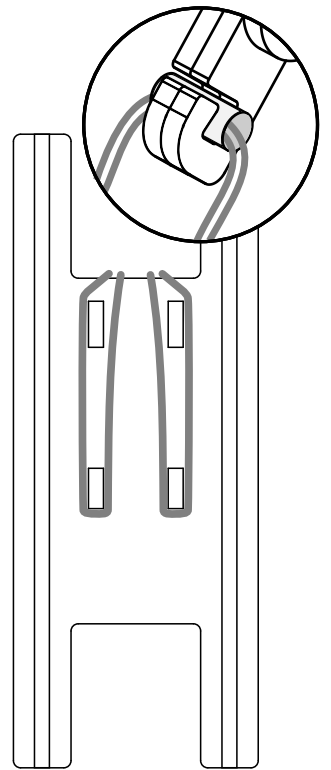
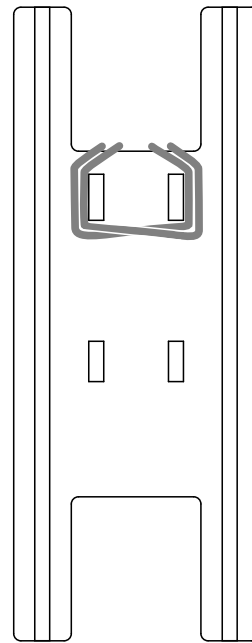
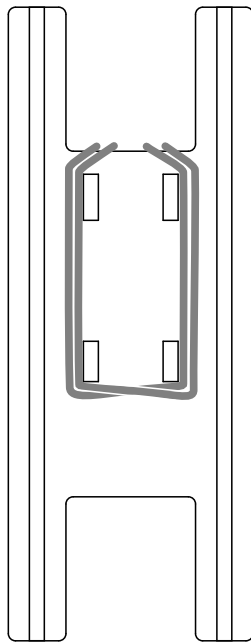
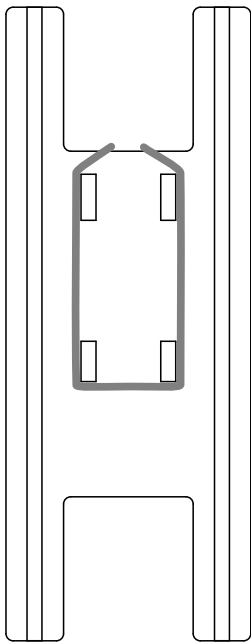
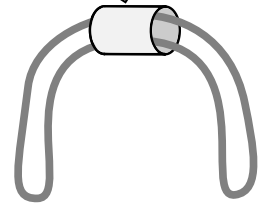
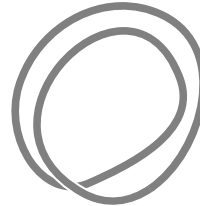
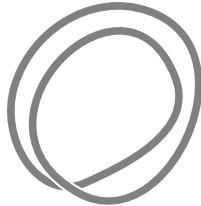
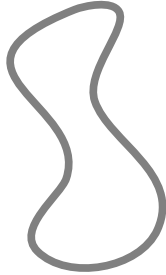
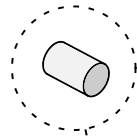

Power:	*	***	**	**
Durability:	***	*	**	****

There are several different ways to attach a rubber band to your catapult. Higher power means longer range. Lower durability means rubber bands will snap more often.